

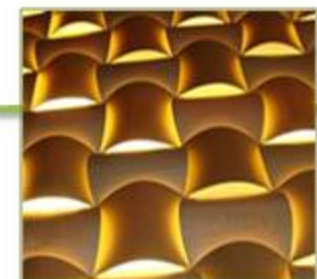

# Infinity – Mammography Clinic

Knowing that every 1 in 8 women will develop invasive breast cancer over the course of her lifetime is a frightening fact. We all hope that it never touches us, ... or if it does touch our life, we hope that it is detected early, so the cure seems possible. We all hope and the hope never dies... It is endless, eternal, infinite! Therefore, the Mammography Clinic bears the name – Infinity.

The symbol for infinity is the main inspiration for the design of the clinic. The floor plan and the reflected ceiling plan follow the elegant curve of the figure eight, creating an environment that will be calming and relaxing. To complement the everlasting hope, the materials used in the design of the clinic are of the highest quality, eco friendly, and durable, which includes rapidly renewable bamboo flooring, under floor heating system, energy efficient medical equipment, eco friendly and low VOC finishes, LED ceiling fixtures, etc.



# ∞ Infinity - Mammography Clinic

## WALLS



Citrine  
SW6714

SW6675  
Afternoon

## Sherwin Williams Pro Industrial™ 0 VOC

- Superior stain resistance
- Superior color and gloss retention
- Effortless application
- Fast dry
- Virtually odorless

## FURNITURE

Dupont Corian is durable: Tough and long-lasting.



## FLOORS

Bamboo is aesthetically pleasing, durable, and made from a rapidly renewable, abundant resource.

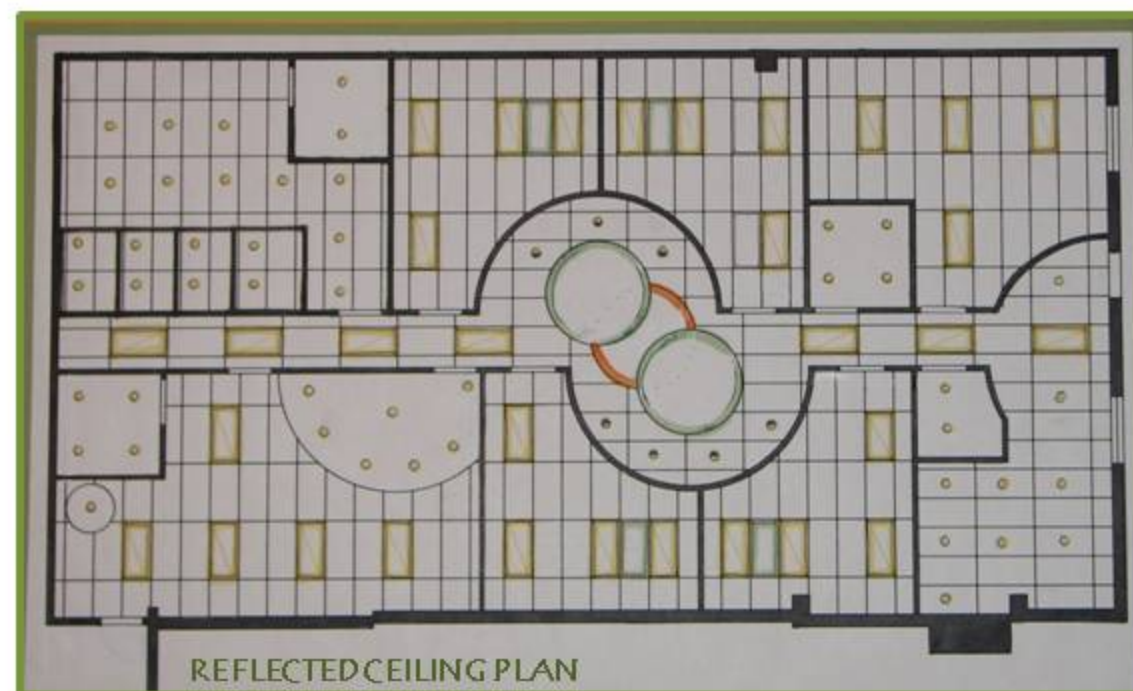

## 60" 120W LED Round Ceiling Fixture

Excellent optics create a uniform beam, delivering lumen output comparable to conventional sources. Free of harmful UV and IR emissions. Available in all color temperatures with excellent color quality.





# Infinity - Mammography Clinic



The underfloor heating system offers clients potential energy savings of up to 30 percent!



**Think chair** - cradle to cradle product certification. Up to 98% recyclable by weight. Up to 37% recycled content.



Dupont Corian (used in the furniture): No grout lines to catch dirt and bacteria. It is a non-porous surface, and does not promote the growth of mold and mildew. It is durable, Tough and long-lasting. GreenGuard Certified as a low emitting material.



Bamboo is durable, made from a rapidly renewable, abundant resource. It also fulfills the following: comfort, low maintenance, infection control, low cost, safety, and aesthetics.



**Exam Table** - VMF Ultra Comfort Seamless Top for the ultimate comfort. It's also easy to clean and helps prevent cross-contamination. Reversible seamless molded drawers eliminate the need to choose a right or left handed table and provide flexibility of room layout.



**Siemens Mammomat Inspiration** - energy efficient medical equipment.



**60" 120W LED Round Ceiling Fixture**  
• 50,000 hour rated life  
• Up to 50% energy savings  
• No flickering



# ∞ Infinity - Mammography Clinic

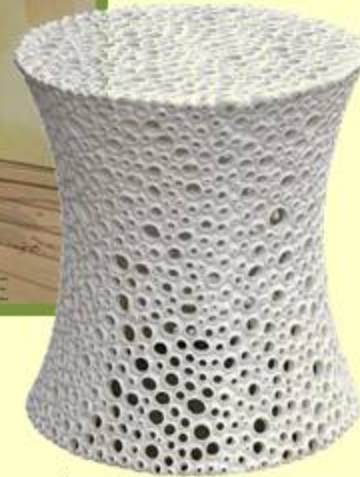

## Entry -

- Eco friendly pierced white resin side table (Oly Studio, Meri Table).
- Ceiling fixture made with Varia Ecoresin, which is a low emitting product, with 40% post-industrial recycled content.



## Reception Desk -

- Station is a combination of Corian and 3form, which is a low emitting product, with 40% post-industrial recycled content.



## Nurses' Station -

- 3form wave wall made with Varia Ecoresin, which is a low emitting product, with 40% post-industrial recycled content.
- Station is a combination of Corian and 3form.

